

- 8P8-RNCC Finish(CC)
- 8P8-RNGS Finish(GS)
- 8P8-RNYY Finish(YY)

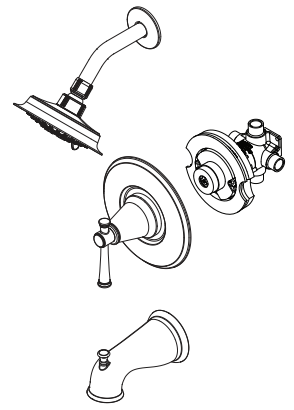

## Specifications

### Features

- 2.5 GPM (Showerhead)
- Multi-Function Showerhead (5 Functions: Drench, Full Spray, Massage, Full Spray/Massage Combo, and Hard Rinse)
- Spot Defense™ Finish Resists Spots and Fingerprints (GS Finish Only)
- Optional Extension Kit (Order 970-083 Separately)
- Ceramic Disc Pforever Seal
- SecurePfit™ with Anti-Handle Wobble
- Includes OX8 Valve
- Pressure Balanced Valve Included
- Quick Connect Tub Spout
- Pforever Warranty®

- SecurePfit™
- Pressure Balanced Valve Included

### Code Compliance

Pfister products are designed and manufactured in compliance with the following standards and codes:

- IAPMO Certified
- CSA B125 Certified
- ASME A112.18.1
- ASSE 1016
- ADA Compliant-ANSI A117.1 (Lever handles only)



## Dimensions

