

- 8P8-WS2-ZLSB Finish(B)
- 8P8-WS2-ZLSC Finish(C)
- 8P8-WS2-ZLSGS Finish(GS)

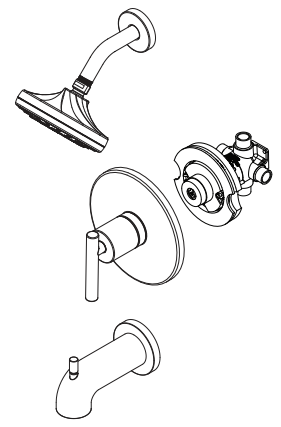

Specifications

Features

- 1.8 GPM Flow Rate (Showerhead)
- 6 Function Showerhead (Full Spray, Massage, Full/Massage Combo, Pause, Lattice, and Lattice/Full Spray)
- Easy to Clean Nozzles
- SecurePfit™ with Anti Handle Wobble
- Spot Defense™ Finish Resists Spots and Fingerprints
- Includes OX8 Valve
- Temperature Limit Stop
- Quick Connect Tub Install
- Pforever Seal Ceramic Disc Valve
- Pforever Warranty®

- SecurePfit™
- Pforever Seal

Code Compliance

Pfister products are designed and manufactured in compliance with the following standards and codes:

- IAPMO Certified to ASME A112.18.1 /CSA B125
- ASSE 1016
- Cal Green Compliant
- CEC Compliant
- EPA WaterSense Certification 1.8 gpm, 6.8L/Min
- ADA Compliant-ANSI A117.1 (Lever handles only)



Dimensions

