

- | | |
|--|---|
| R89-1DMTC Finish(C) <input type="checkbox"/> | R89-7DMT1C Finish(C) <input type="checkbox"/> |
| R89-1DMTGS Finish(GS) <input type="checkbox"/> | R89-7DMT1GS Finish(GS) <input type="checkbox"/> |
| R89-1DMTSDB Finish(SDB) <input type="checkbox"/> | R89-7DMT1SDB Finish(SDB) <input type="checkbox"/> |
| R89-1DMTSDBG Finish(SDBG) <input type="checkbox"/> | R89-7DMT1SDBG Finish(SDBG) <input type="checkbox"/> |

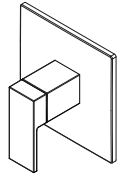
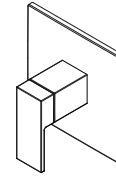
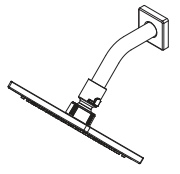

Specifications

Features

- 1.75 GPM Flow Rate (7DMT1 Only)
- SecurePfit™ with Anti-Handle Wobble
- Tub Spout Not Included
- Requires OX8/JX8 Valve (Sold Separately)
- Trim Only, Valve Not Included
- Temperature Control Only
- Quick Connect Showerhead Included (7DMT1)
- Shower and Flange (7DMT1)
- Flange Only (1DMT1)
- Spot Defense™ Finish Resists Spots and Fingerprints (DMTC Excluded)
- Limited Lifetime Warranty

- SecurePfit™
- Trim Only, Valve Not Included

Code Compliance

Pfister products are designed and manufactured in compliance with the following standards and codes:

- IAPMO Certified to ASME A112.18.1/CSA B125.1
- CEC Certified/CALGreen compliant
- EPA WaterSense Certified
- ADA Compliant - ANSI A117.1 (Lever Handles Only)



Dimensions

